

Eclipse ThermJet Burners

for preheated combustion air

Model TJPCA0300
Version 2

PARAMETER		SPECIFICATION		
		Nat. Gas	Propane	Butane
Maximum Input Btu/hr (kW)		3,000,000 (879)	3,000,000 (879)	3,000,000 (879)
Minimum Input, On-ratio Btu/hr (kW)		300,000 (88)	300,000 (88)	300,000 (88)
Gas Inlet Pressure "w.c. (mbar) • Fuel pressure at gas inlet (Tap "B"– see page 3)	ambient	6.0 (14.9)	6.8 (16.9)	6.0 (14.9)
	300° F	7.8 (19.5)	8.6 (21.4)	7.8 (19.5)
	700° F	11.2 (27.7)	12.0 (29.7)	11.2 (27.7)
	1000° F	13.7 (33.9)	14.5 (35.9)	13.7 (33.9)
Air Inlet Pressure "w.c. (mbar) • 15% excess air at maximum input (Tap "A" – see page 3)	ambient	4.5 (11.2)	4.5 (11.2)	4.5 (11.2)
	300° F	6.3 (15.7)	6.3 (15.7)	6.3 (15.7)
	700° F	9.7 (24.2)	9.7 (24.2)	9.7 (24.2)
	1000° F	12.2 (30.4)	12.2 (30.4)	12.2 (30.4)
High Fire Flame Length Inches (mm)		<64.0 (1630)	<66.0 (1675)	<68.0 (1730)
Flame Detection		U.V. scanner available for all combustors		
Fuel		Natural Gas, Propane, Butane <i>For any other mixed gas, contact Eclipse for orifice sizing.</i>		

- All information is based on laboratory testing in neutral (0.0"w.c.) pressure chamber. Different chamber size and conditions may affect the data.
- All information is based on standard combustor design. Changes in the combustor will alter performance and pressures.
- All inputs based upon gross calorific values.
- Eclipse reserves the right to change the construction and/or configuration of our products at any time without being obliged to adjust earlier supplies accordingly.
- Plumbing of air and gas will affect accuracy of orifice readings. All information is based on generally acceptable air and gas piping practices.

Performance Graphs

Ignition & Operational Zones

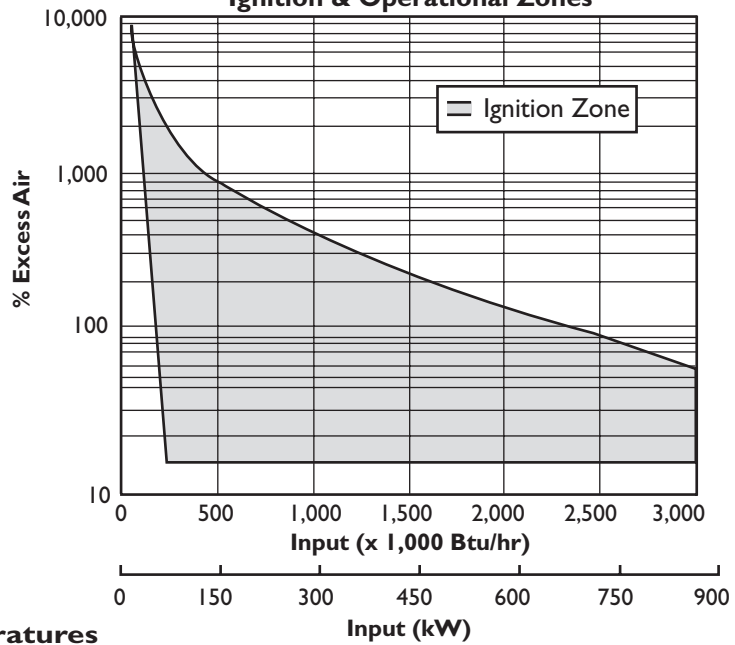

NO_x vs Preheated Air Temperatures (Based on Maximum Firing Rate)

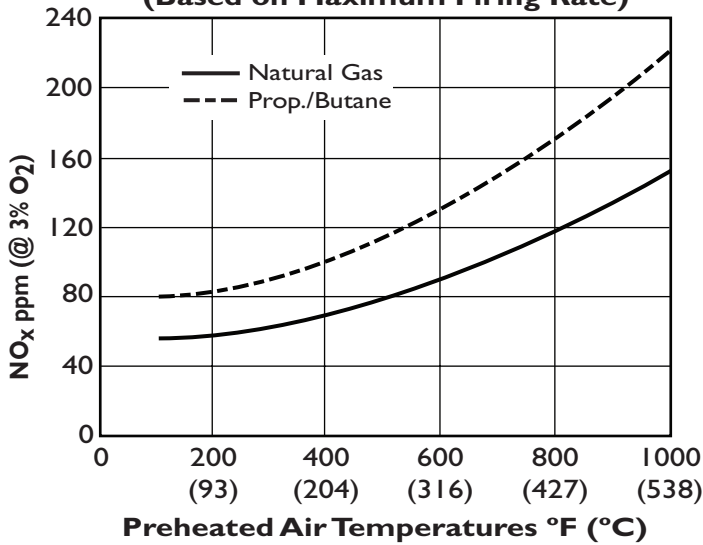

Emissions from the burner are influenced by:

- Fuel type
- Combustion air temperature
- Firing rate
- Chamber Conditions
- Percent of excess air

For estimates of other emissions, contact Eclipse.

Gas Orifice ΔP vs. Input (Measured from Tap B to Tap D)

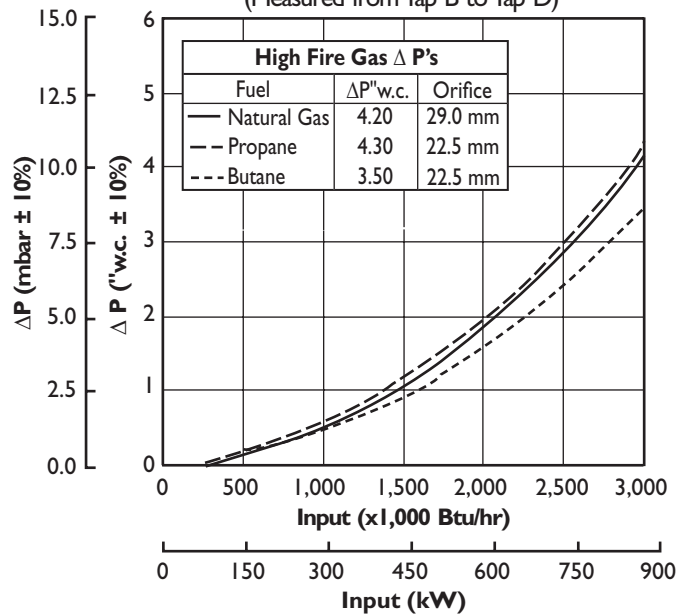

Dimensions & Specifications Millimeters (Inches)

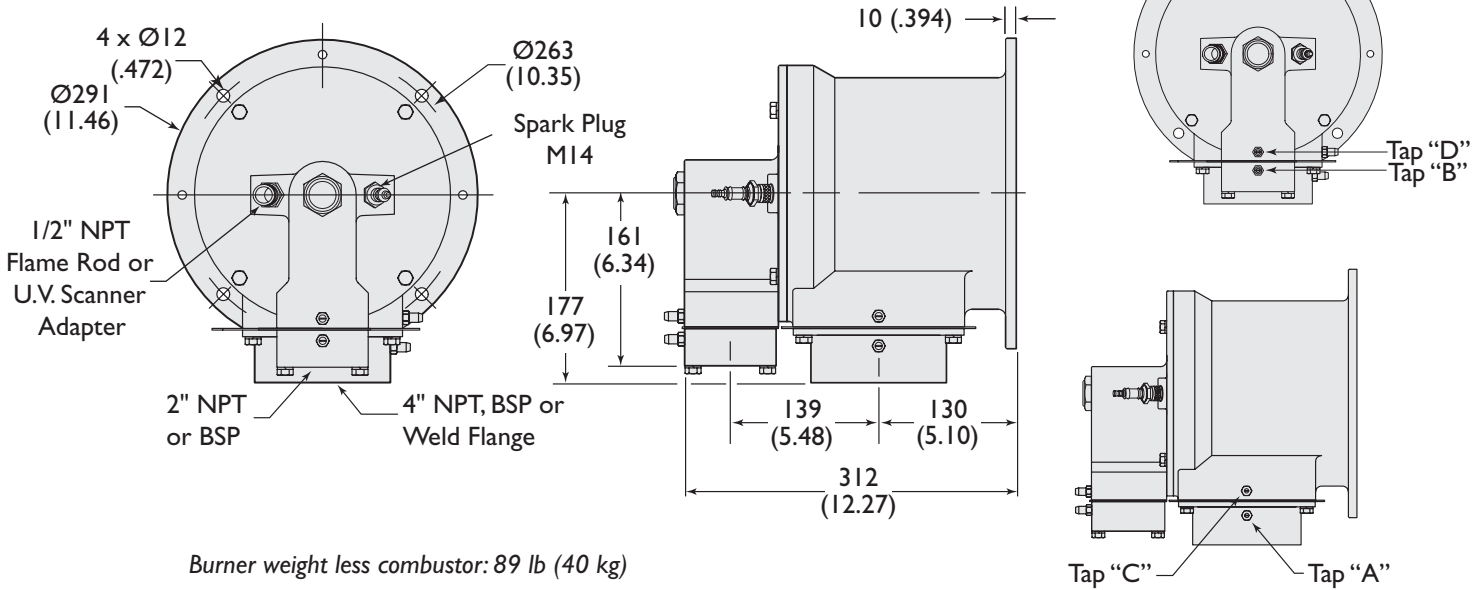

Combustor

Exhaust outlet diameter : High Velocity : Ø100 (3.937)
Medium Velocity : Ø135 (5.315)

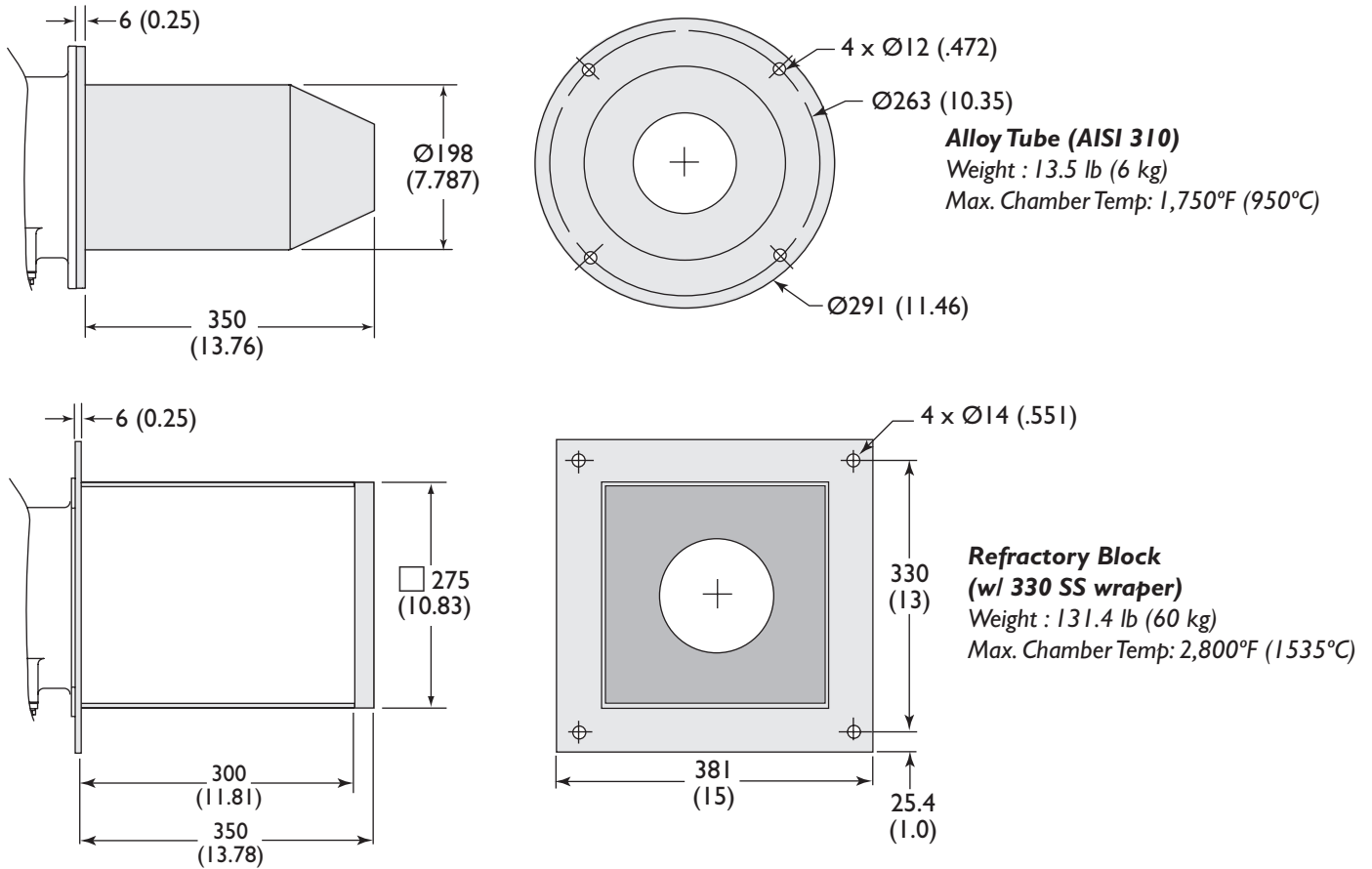

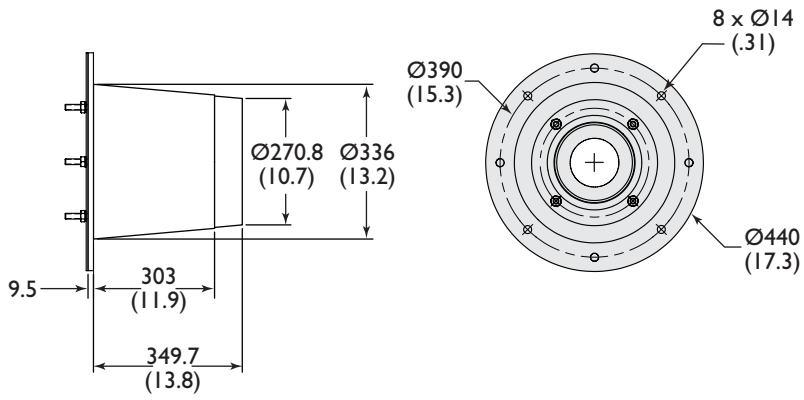

Down Firing Block
 Weight: 135 lb (61.23 kg)
 Max. Chamber Temp: 2800°F (1535°C)



Offered By:

Power Equipment Company
2011 Williamsburg Road
Richmond, Virginia 23231
Phone (804) 236-3800
Fax (804) 236-3882

www.peconet.com